

OFFICE HOURS:

Monday to Friday	9 am	to	5 pm
Saturday	9 am	to	2 pm
Sunday and Bank Holidays	12 noon	to	2 pm



10 good reasons to choose DMA

- * *Open 7 days a week.*
- * *Filey's longest established family run independent estate agency.*
- * *Prompt efficient friendly service.*
- * *360° virtual tours and floor plans.*
- * *Free advertising: no sale - no charge.*
- * *Free no obligation market valuation.*
- * *Free accompanied viewing.*
- * *Dedicated sales progression.*
- * *Prominent town centre location.*
- * *Modern walk-round self selection display.*

RESIDENTIAL
SALES

DMA ESTATE
AGENTS

COMMERCIAL
SALES



Proprietors: **David Mansfield ATTON FNAEA.**
Gavin Ashley Mansfield ATTON MNAEA / DEA. Samantha ADDISON
www.dmaestateagents.co.uk

ESTABLISHED 1992



These particulars are intended only to give a fair description of the property, as a guide to prospective buyers. Accordingly a) their accuracy is not guaranteed and neither DMA Estate Agents nor the vendor(s) accept any liability in respect of their contents; b) they do not constitute an offer or contract of sale, and c) any prospective purchaser should satisfy themselves by inspection or otherwise as to the correctness of any statement or information in these particulars.

DMA

ESTATE
AGENTS

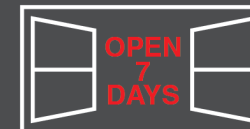

15 CHAPEL COURT, WEST AVENUE, FILEY YO14 9AB



Leasehold £76,500

FEATURES

- * One bedroom first floor apartment specially designed for retirement.
- * Convenient for all Filey's town centre shops, doctors' surgery, bus and train stations.
- * Built to a high standard by McCarthy and Stone in late 1980's.
- * Upvc double glazing.
- * Lift to all floors.
- * Laundrette and communal Residents' Lounge.
- * Security telephone to main entrance doors.
- * **Sold with no onward chain.**
- * **EPC Rating: C.**
- * Viewing is highly recommended.

ACCOMMODATION IN BRIEF

GROUND FLOOR: Front Door to main Communal Entrance Foyer.
Residents' Lounge.

Stairs and Lift to FIRST FLOOR:
Own Door to: Entrance Hall. Lounge. Kitchenette. Bedroom.
Shower Room.

OUTSIDE: Communal gardens.
Parking to the rear (subject to availability).

26 Belle Vue Street, FILEY, North Yorks. YO14 9HY. Telephone: 01723 515527
www.dmaestateagents.co.uk / www.rightmove.co.uk

15 CHAPEL COURT, WEST AVENUE, FILEY

Front Door via Security Intercom System to:

COMMUNAL ENTRANCE FOYER

COMMUNAL RESIDENTS' LOUNGE

Stairs and Lift to FIRST FLOOR:

Own Door to:

ENTRANCE HALL

Large coats cupboard with immersion tank.

LOUNGE

5.31m x 1.83m (17'5" x 10'7")

Electric fire. Electric night storage heater. Upvc double glazed window.



Archway to:

/ continued over

KITCHENETTE

Inset stainless steel sink and drainer. Base cupboards with worktops over. Matching wall cupboards. Electric cooker point. Extractor fan. Upvc double glazed window.



BEDROOM

4.29m x 2.67m (14'1" x 8'9")

Electric night storage heater. Built-in wardrobes with mirror doors. Upvc double glazed window.



SHOWER ROOM

Corner enclosed shower cubicle with 'Mira Sport' electric shower, handbasin and wc. Extractor fan. Tiled walls.

OUTSIDE:

Communal gardens. Possible parking space (subject to availability).

TENURE

Leasehold: Ground Rent: approx. £440.00 per annum.
Service Charge: approx. £2,250.00 per annum.
due September and March each year.

Floor Plan:

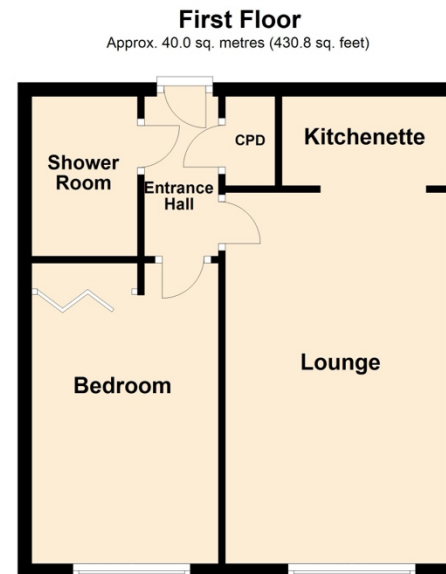

Total area: approx. 40.0 sq. metres (430.8 sq. feet)

Please note this floor plan is a guide and not to scale.
Plan produced using PlanUp.

15 Chapel Court, West Avenue, Filey

Council Tax Band B.

DIRECTIONS:

On foot from the DMA office, turn left along Belle Vue Street and turn right at the end onto West Avenue. Chapel Court is located on the left hand side on the corner of Station Avenue.

Viewing strictly by appointment only through DMA Estate Agents